

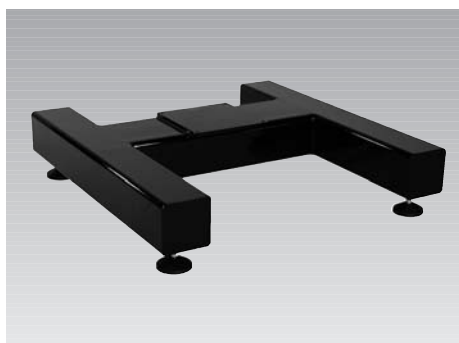

## Floor Module FMS

Max. load 6.000 N, with one *modulog* interface



### Advantages:

- Stable steel construction with high load capacity
- Height-adjustable feet
- Solid and upright position even on uneven floors
- Good accessibility
- Suitable for workshop setups
- Suitable as base frame for working tables
- *modulog* interface

### Application

Floor modules for use as base frame for height-adjustable working places.

Working stations or height-adjustable working tables can be easily realised with floor modules combined with lifting units.

Floor modules are a stable base that can be adapted to uneven floors for further setups with high stability.

### Principal use

- Production plants
- Test area for quality assurance
- Height-adjustable standing working places
- Height-adjustable working tables

### Installation

The floor module with adjustable feet has to be adjusted so that all sides are supported on the floor.

Afterwards the adjustable feet have to be locked by lock nuts.

### Important notes

When installing the floor module pay attention to a stable floor.

Protruding loads have to be avoided as this may cause instability.

### Description

The floor module FMS consists of a welded, stable steel frame with four height-adjustable feet.

The adjustable feet have a steel thread and are equipped with a stable spherical cap.

In the centre of the steel frame a mounting plate with a *modulog* interface 200 x 200 is fixed. This plate is used to fix *modulog* modules.

Alternatively workshop setups can be mounted onto the steel frame.

### Material

Frame: steel, black-lacquered

### Mounting

For mounting of *modulog* modules or other components the floor module has in the centre of the steel frame an interface 200 x 200.

As accessory an adaptor plate is available to mount *modulog* modules with interface 140 x 140.

To combine working tables appropriate table plates with handles are available as accessory.

### *modulog*

#### Floor module FMS

Part-no. 8901-06-01-O

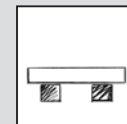

### Technical characteristics

Max. load: 6,000 N

### Combinable with the modules

- Rotating module - vertical axis DMV 1000 as per data sheet M 3.101



- Lifting modules as per data sheet M 4.XXX



### *modulog* interface

- 200 x 200 - M10

### Accessories

- Table plates as per data sheet M 8.130

### Application example



Floor module FMS 600 with mounted electrical lifting module Shop-Floor.

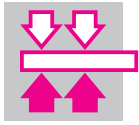

### Maximum admissible load $F_z$

Due to stability reasons, only symmetrical load is admitted for the floor module.

**Maximum admissible load  $F_z = 6,000\text{ N}$**

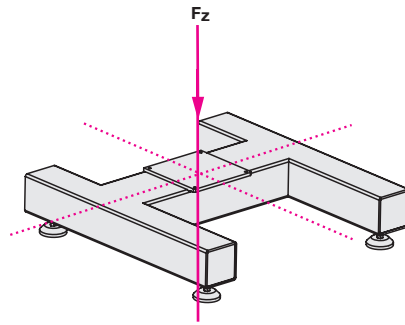

**Part-no. 8901-06-01-O**

### Accessories

● **Adaptor plate 140 - 200**  
to mount *modulog* modules with interface  
140 x 140

**Part-no. 6311-417**

See data sheet M 8.110

● **Table plates made of wood or steel**

See data sheet M 8.130

### Spare part

● **Adjustable foot**

**Part-no. 6351-568**

### Dimensions

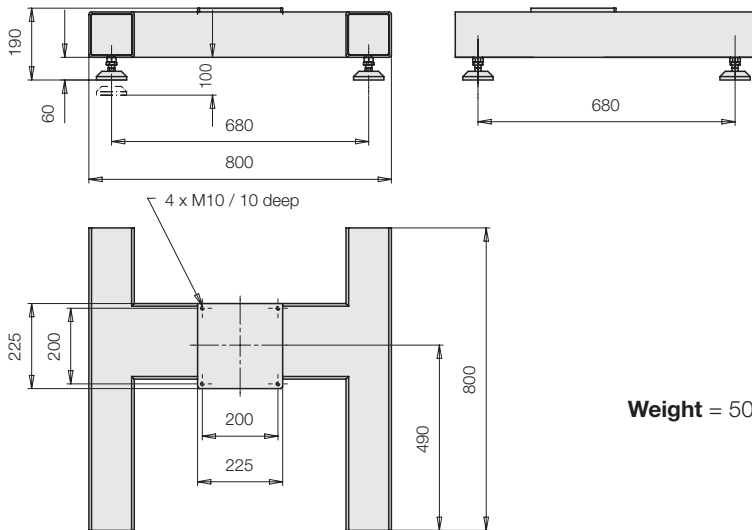

**Weight = 50 kg**